

COIL SPECIFICATION

CUSTOMER	110157	PART NO.	930555B-9009
PART NAME	DATA SHEET	DATE	2005/2/18
		SPEC (TYPE)	SMI-565050-102K

■ **PRODUCT IDENTIFICATION**

① ② ③ ④

SMI-565050-102K

- ① Product Code
- ② Dimensions Code
- ③ Inductance Code
- ④ Tolerance Code

■ **SHAPE&DIMENSION (mm)**

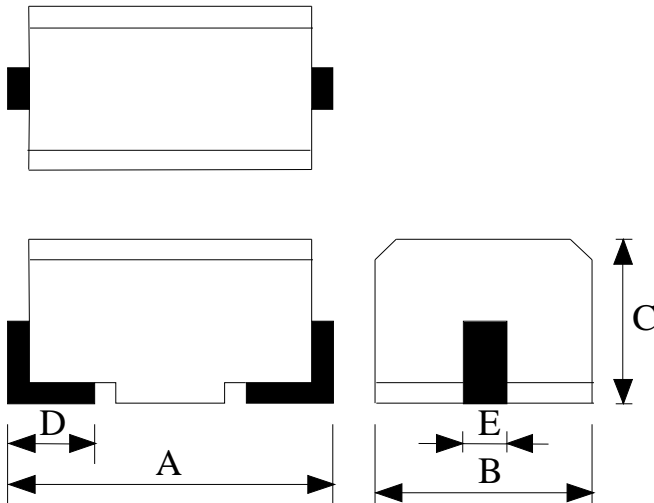

A	5.60±0.50
B	5.00±0.50
C	5.00±0.50
D	1.00±0.30
E	2.00±0.30

ELECTRICAL REQUIREMENTS				TEST INSTRUMENTS	
L	1000±10%uH	TEST FREQ.	0.252MHz		*HP 4285A LCR METER
Q	20 ⁻⁰	TEST FREQ.	0.252MHz		*ZENTECH 502 AC LOW-OHM METER
RDC	15.0 ⁺⁰ OHM	TEST FREQ.			
SRF	1.8 ⁻⁰ MHz	TEST FREQ.			



COIL SPECIFICATION

CUSTOMER	110157	PART NO.	930555B-9009
PART NAME	DATA SHEET	DATE	2005/2/18
		SPEC (TYPE)	SMI-322522-102K-RU

PART NO	INDUCTANC (μ H)	Q Min.	TEST FREQ (MHz)	SRF(MHZ) Min.	RDC(Ω) Max.	IDC(Ma) Max.
SMI-565050-1R0K	1.00 \pm 10%	10	7.96	95	0.030	1800
SMI-565050-1R2K	1.20 \pm 10%	10	7.96	70	0.035	1700
SMI-565050-1R5K	1.50 \pm 10%	10	7.96	55	0.04	1600
SMI-565050-1R8K	1.80 \pm 10%	10	7.96	47	0.05	1400
SMI-565050-2R2K	2.20 \pm 10%	10	7.96	42	0.05	1300
SMI-565050-2R7K	2.70 \pm 10%	10	7.96	37	0.07	1200
SMI-565050-3R3K	3.30 \pm 10%	10	7.96	34	0.08	1120
SMI-565050-3R9K	3.90 \pm 10%	10	7.96	32	0.09	1050
SMI-565050-4R7K	4.70 \pm 10%	10	7.96	29	0.11	950
SMI-565050-5R6K	5.60 \pm 10%	10	7.96	26	0.13	880
SMI-565050-6R8K	6.80 \pm 10%	10	7.96	24	0.15	810
SMI-565050-8R2K	8.20 \pm 10%	10	7.96	22	0.18	750
SMI-565050-100K	10.0 \pm 10%	10	2.52	19	0.21	690
SMI-565050-120K	12.0 \pm 10%	10	2.52	17	0.25	630
SMI-565050-150K	15.0 \pm 10%	10	2.52	16	0.30	580
SMI-565050-180K	18.0 \pm 10%	10	2.52	14	0.36	530
SMI-565050-220K	22.0 \pm 10%	10	2.52	13	0.43	480
SMI-565050-270K	27.0 \pm 10%	10	2.52	11.5	0.52	440
SMI-565050-330K	33.0 \pm 10%	10	2.52	10.5	0.62	400
SMI-565050-390K	39.0 \pm 10%	10	2.52	9.5	0.72	370
SMI-565050-470K	47.0 \pm 10%	10	2.52	8.5	0.85	340
SMI-565050-560K	56.0 \pm 10%	10	2.52	7.8	1.0	310
SMI-565050-680K	68.0 \pm 10%	10	2.52	7.0	1.2	290
SMI-565050-820K	82.0 \pm 10%	10	2.52	6.4	1.4	270
SMI-565050-101K	100 \pm 10%	20	0.796	6.0	1.6	250
SMI-565050-121K	120 \pm 10%	20	0.796	5.4	1.9	230
SMI-565050-151K	150 \pm 10%	20	0.796	4.8	2.2	210
SMI-565050-181K	180 \pm 10%	20	0.796	4.4	2.8	190
SMI-565050-221K	220 \pm 10%	20	0.796	3.9	3.4	170
SMI-565050-271K	270 \pm 10%	20	0.796	3.6	4.2	155
SMI-565050-331K	330 \pm 10%	20	0.796	3.2	4.9	140
SMI-565050-391K	390 \pm 10%	20	0.796	2.9	5.8	130
SMI-565050-471K	470 \pm 10%	20	0.796	2.6	7.0	120
SMI-565050-561K	560 \pm 10%	20	0.796	2.4	8.5	110
SMI-565050-681K	680 \pm 10%	20	0.796	2.2	10	100
SMI-565050-821K	820 \pm 10%	20	0.796	2.0	13	90
SMI-565050-102K	1000 \pm 10%	20	0.252	1.8	15	85



COIL SPECIFICATION

CUSTOMER	110157	PART NO.	930555B-9009
PART NAME	MECHANICAL PERFORMANCE	DATE	2005/2/18
		SPEC (TYPE)	SMI-322522-102K

MECHANICAL PERFORMANCE TEST

VIBRATION TEST (LOW FREQUENCY)	1. INDUCTORS SHALL BE NO EVIDENCE OF ELECTRICAL AND MECHANICAL DAMAGE 2. INDUCTANCE SHALL NOT CHANGE MORE THAN $\pm 5\%$	1. AMPLITUDE: 1.5m/m 2. FREQUENCY: 10-55-10HZ/1MIN 3. DIRECTION: X, Y, Z
SHOCK TEST	3. Q SHALL NOT CHANGE MORE THAN $\pm 20\%$	INDUCTORS SHALL BE DROPPED 10 TIMES FROM A HEIGHT OF 1m ONTO 3cm WOODEN BOARD
RESISTANCE TO SOLDERING HEAT	1. INDUCTANCE SHALL NOT CHANGE MORE THAN $\pm 10\%$ 2. Q SHALL NOT CHANGE MORE THAN $\pm 20\%$	TEMP: $260 \pm 5^\circ\text{C}$ TIME: 10 ± 1.0 SEC
TERMINAL STRENGTH PULL TEST	TERMINAL SHALL NOT BE LOOSENED OR RUPTURED	A 1KG LOAD SHALL BE APPLIED TO BOTH TERMINALS IN THE AXIS DIRECTION FOR 1 MINUTE. (0.5KG FOR SMI-322522 SERIES)
SOLDERABILITY TSET	THE TERMINAL SHALL BE AT LEAST 90% COVERED WITH SOLDER	AFTER FLUXING, INDUCTOR SHALL BE DIPPED IN A MELTED SOLDER BATH AT $230 \pm 5^\circ\text{C}$ FOR 5 SECONDS.
RESISTANCE TO SOLVENT TEST	THERE SHALL BE NO CASE DEFORMATION CHANGE IN APPEARANCE OR OBLITERATION OF MARKING	MIL-STD-202F, METHOD 215D

CLIMATIC TEST

ITEM	SPECIFICATION	TEST CONDITION
THERMAL SHOCK (TEMPERATURE CYCLE)	NO MECHANICAL DAMAGE. INDUCTANCE SHALL BE WITHIN $\pm 10\%$	TEMPERATURE : $-40^\circ\text{C}, 85^\circ\text{C}$ FOR 30 MINUTES EACH, 100 CYCLES.
HUMIDITY RESISTANCE	OF THE INITIAL VALUE, AND Q (SHALL BE) WITHIN $\pm 20\%$ OF THE INITIAL VALUE.	TEMPERATURE : 40°C HUMIDITY : 95% RH TIME : 1000 ± 12 HOURS
HIGH TEMPERATURE RESISTANCE		TEMPERATURE : $85^\circ\text{C} \pm 2^\circ\text{C}$ TIME : 1000 ± 12 HOURS
LOW TEMPERATURE RESISTANCE		TEMPERATURE : $-40^\circ\text{C} \pm 2^\circ\text{C}$ TIME : 1000 ± 12 HOURS

NOTE :

1. OPERATING TEMPERATURE RANGE -25°C TO $+85^\circ\text{C}$
2. STORAGE TEMPERATURE RANGE -40°C TO $+85^\circ\text{C}$



COIL SPECIFICATION

CUSTOMER	110157	PART NO.	930555B-9009
PART NAME	CARRIER & REEL	DATE	2005/2/18
		SPEC (TYPE)	SMI-322522-102K

PACKAGING

CARRIER TAPE REELS

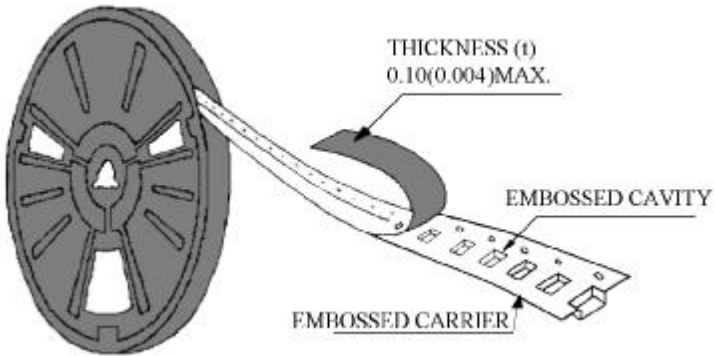

The force for tearing off cover tape is 10to70 grams in the arrow direction

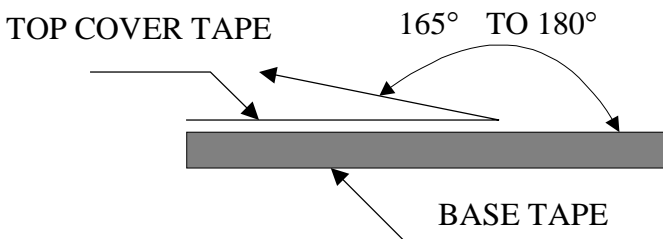

REEL DIMENSION

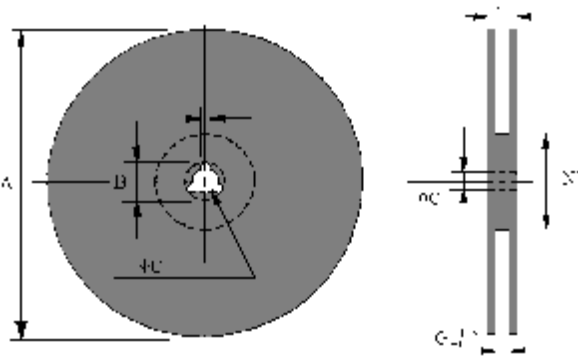

Part Number	TYPE	A	B	C	G	N	T	PCS
SMI-322522	8mm	178	21.0±0.8	13.0±0.2	8.4	55	12.4	2000/1000
SMI-453232	12mm	178	21.0±0.8	13.0±0.2	12.4	55	16.4	500
SMI-565050	16mm	330	23.0±0.8	13.0±0.2	16.4	100	20.4	1000

