

(1) SHAPES AND DIMENSIONS

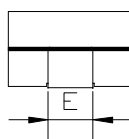
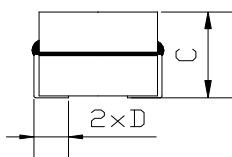
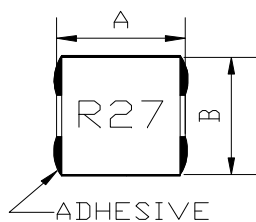

- A: 11.2 Max. mm
- B: 11.2 Max. mm
- C: 9.00 Max. mm
- D: 2.54 Typ. mm
- E: 2.03 Typ. mm

(2) ELECTRICAL SPECIFICATIONS SEE TABLE 1

TEST INSTRUMENTS

- L : HP 4284A PRECISION LCR METER (or equivalent)
- RDC : CHROMA MODEL 16502 MILLIOHM METER (or equivalent)
- IDC1 : CH3302/G LCR METER
CH1320, CH1320S BIAS CURRENT SOURCE (or equivalent)

(3) CHARACTERISTICS

- (3)-1 Ambient temperature +60°C Max.
- (3)-2 Operate temperature range -40°C ~ +125°C
(Including self temp. rise)
- (3)-3 Storage temperature range -40°C ~ +125°C

TABLE 1

MAGLAYERS PT/NO.	Inductance L(μH)	Percent Tolerance	Test Frequency	Resistance RDC(mΩ)	Rated DC Current		Marking
					IDC1(A)	IDC2(A)	
MSI-111109-R22□	0.225	M,N	100kHz/0.1V	0.63±9.5%	68	35	R22
MSI-111109-R27□	0.270	M,N	100kHz/0.1V	0.63±9.5%	50	35	R27
MSI-111109-R32□	0.325	M,N	100kHz/0.1V	0.63±9.5%	43	35	R32
MSI-111109-R47□	0.470	M,N	100kHz/0.1V	0.63±9.5%	30	35	R47

- ※ □ specify the inductance tolerance, M(±20%), N(±30%)
- ※ IDC1 : Based on inductance change ($\Delta L/L_0$: drop 20% TYP.) @ ambient temp. 25°C
- IDC2 : Based on temperature rise (ΔT : 40°C TYP.)
- Rated DC Current : The less value which is IDC1 or IDC2 .

RDC TEST POINT

The nominal DCR is measured from point "a" to point "b" .

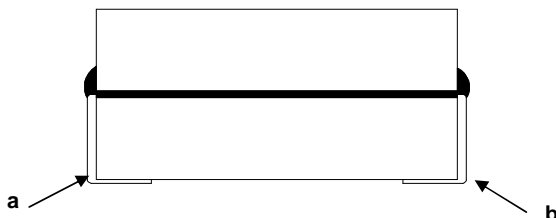

LAND PATTERN DIMENSIONS(mm)

(STANDARD PATTERN)

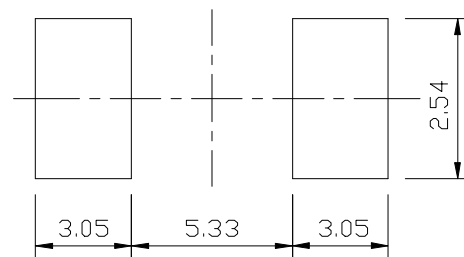

(4) PACKAGING

(4)-1 CARRIER TAPE DIMENSIONS (mm)

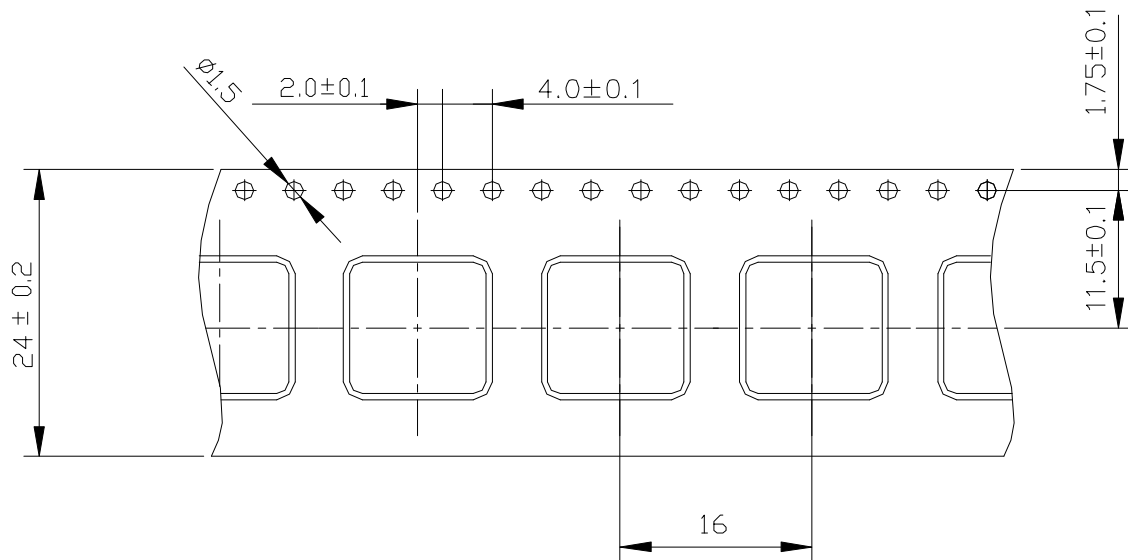

(4)-2 TAPING DIMENSIONS (mm)

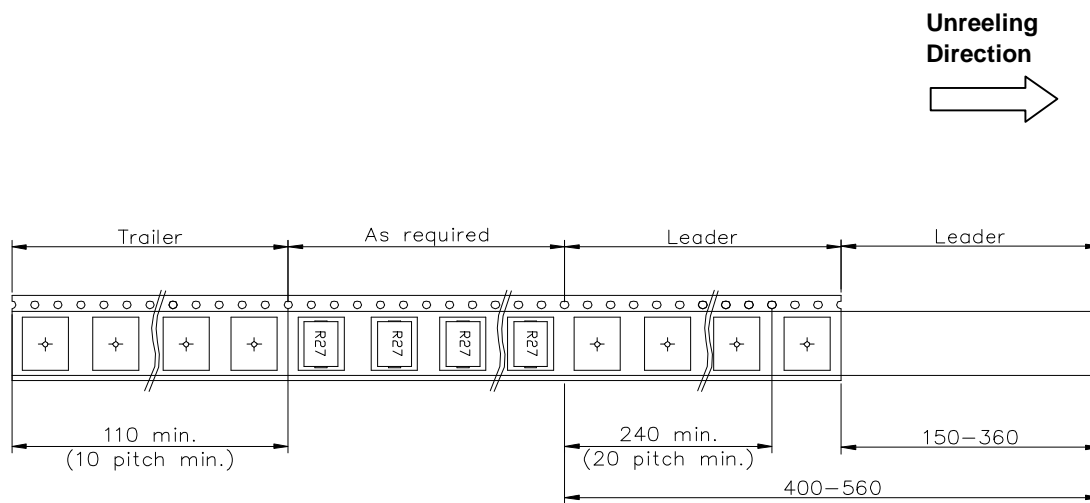

(4)-3 REEL DIMENSIONS (mm)

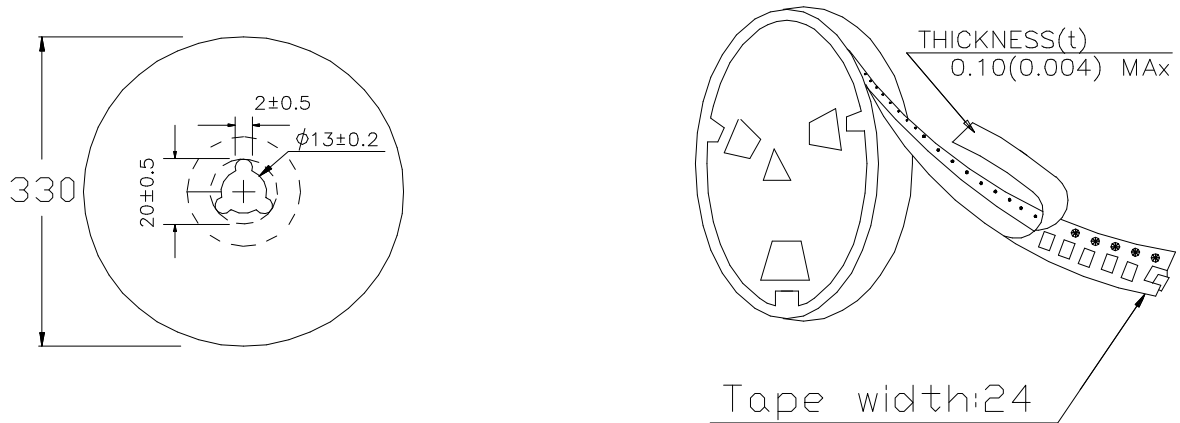

(4)-4 QUANTITY

300pcs/Reel

The products are packaged so that no damage will be sustained.

TYPICAL ELECTRICAL CHARACTERISTICS

INDUCTANCE vs. DC CURRENT@100kHz/0.1V

Ambient Temperature : 25°C

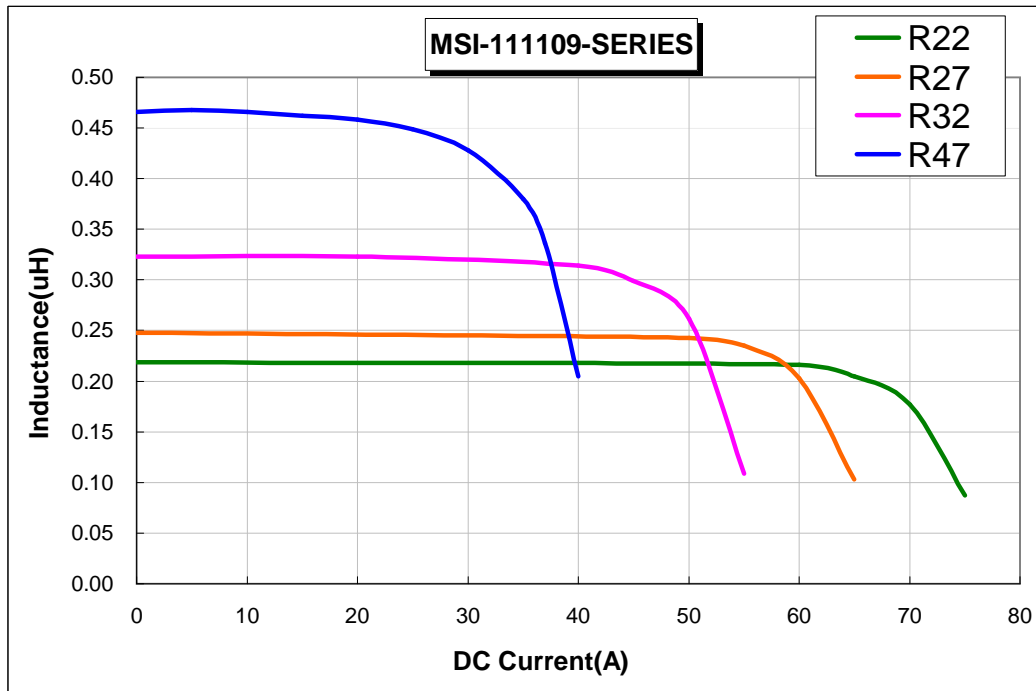

Temperature Rise vs. DC Current

