



Networking Communication Components

RT Series

LAN Transformer

Part number: RT42H01

Part name :Giga Transformer Four Port

Feature

- | |
|--|
| ● Compliant and peak reflow temperature rating 255°C . |
| ● Meets IEEE802.3 specification. |
| ● Excellent common mode noise suppression. |
| ● Packaging specification is tube.
(RT42H□□ : Tube) |

Part number code

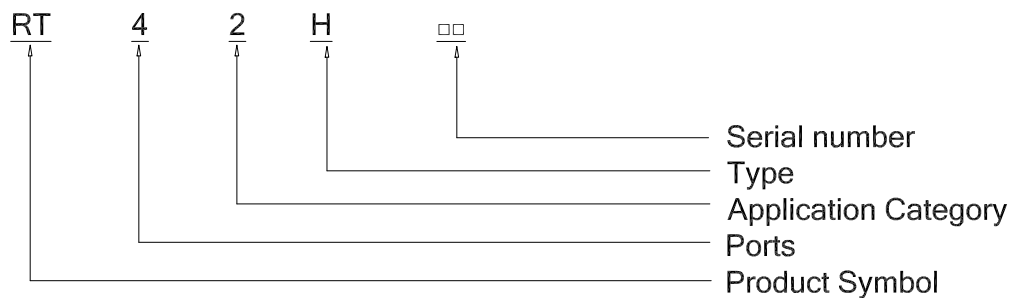

REV.	Description	Date	Drawn	Designed	Approved
A	Specification issued	05.31.2011	Allen.Yu	Allen.Yu	James.Cheng
B	Mechanical Dimension change : B : 18.97mm -> 19.00mm ; D : 4.30mm -> 3.00mm	07.23.2012	Yuxuan.Xiang	Yuxuan.Xiang	James.Cheng

Mechanical Dimension and Marking

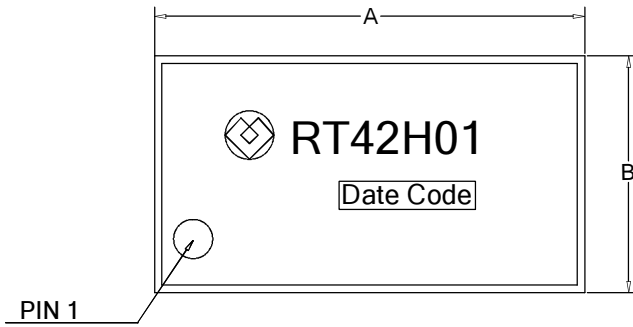

UNIT	mm	inch
A	34.50 +0.254/-0.254	1.358 +0.010/-0.010
B	19.00 +0.254/-0.254	0.748 +0.010/-0.010
C	13.00 +0.254/-0.254	0.511 +0.010/-0.010
D	3.00 +0.254/-0.254	0.118 +0.010/-0.010
E	0.40 +0.127/-0.127	0.016 +0.005/-0.005
F	1.78 +0.254/-0.254	0.070 +0.010/-0.010
G	0.89 +0.127/-0.127	0.035 +0.005/-0.005
H	31.15 +0.254/-0.254	1.226 +0.010/-0.010
I	10.54 +0.254/-0.254	0.415 +0.10/-0.010
J	15.62 +0.254/-0.254	0.615 +0.010/-0.010

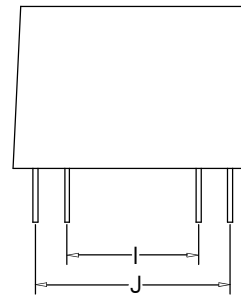
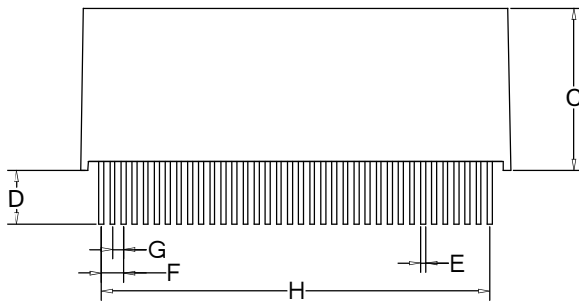
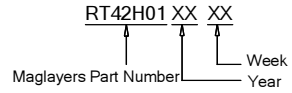

Suggested PWB Layout

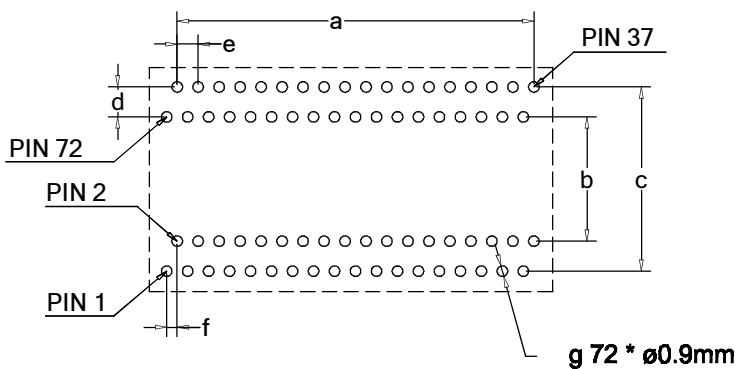

UNIT	mm	inch
a	30.26	1.191
b	10.54	0.415
c	15.62	0.615
d	2.54	0.100
e	1.78	0.070
f	0.89	0.035
g	ø0.90	ø0.035

Drawn	Allen.Yu	Designed	Allen.Yu	Approved	James.Cheng
-------	----------	----------	----------	----------	-------------

Schematics

RT42H01

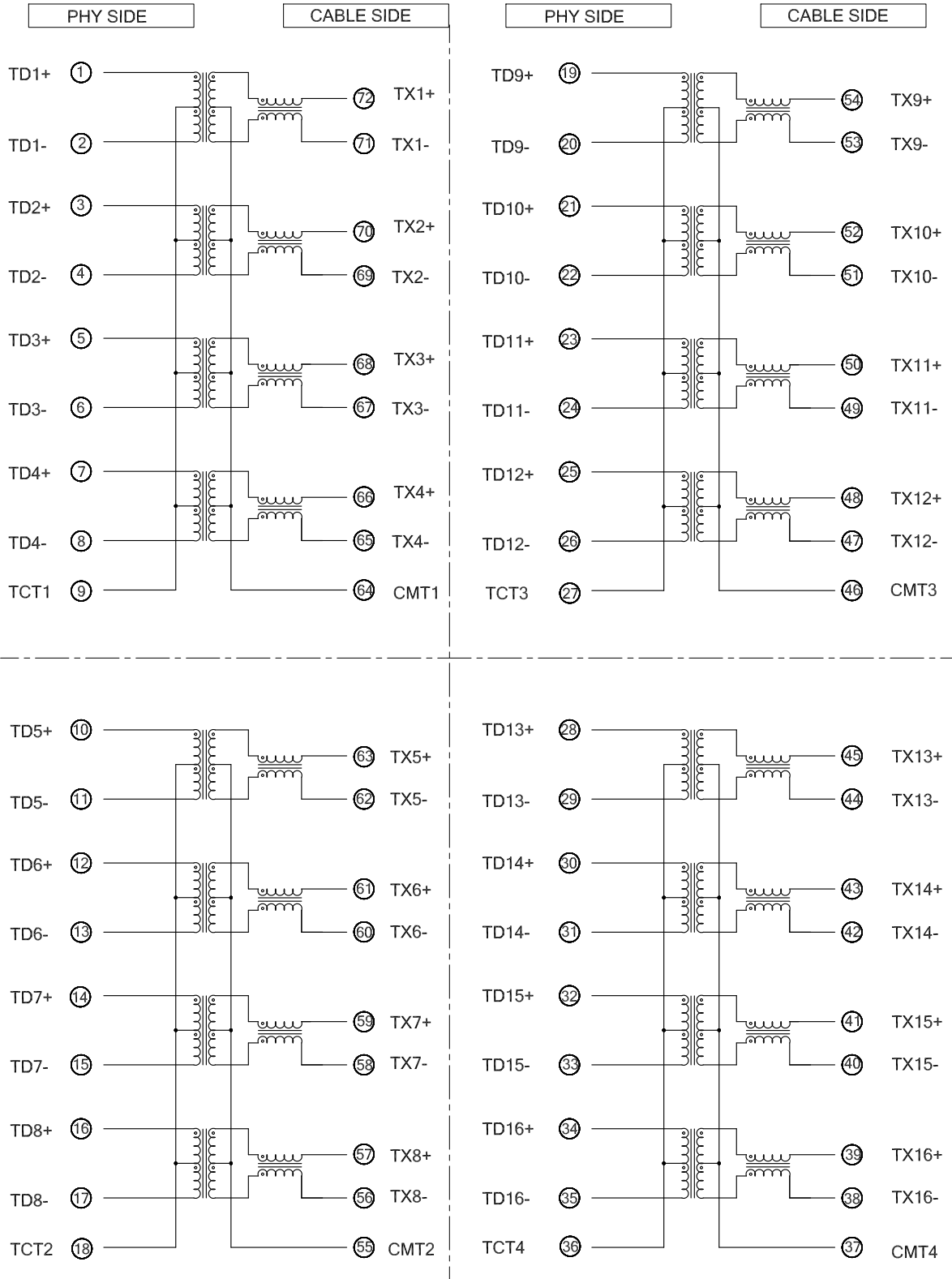



Electrical Specification @ 25°C, Humidity 65% RH

Primary Inductance
100KHz, 0.1V, 8mA DC Bias
350uH MIN

Part Number	Turns Ratio	Insertion Loss	Return Loss					DMCR			Crosstalk			Hipot
	100KHz	dB MAX	dB MIN					dB MIN			dB MIN			Vrms, Sec
	± 3%	1MHz-100MHz	1MHz-30MHz	40MHz	50MHz	60MHz-80MHz	100MHz	30MHz	60MHz	125MHz	30MHz	60MHz	100MHz	Pri To Sec
RT42H01	1:1	-1	-18	-14.4	-13.1	-12	-10	-40	-35	-30	-40	-35	-30	1500, 60

Operating Temperature : -40°C to +85°C.
Storage Temperature : -25°C to +105°C
JSDEC Moisture : Level 1

Wave Soldering

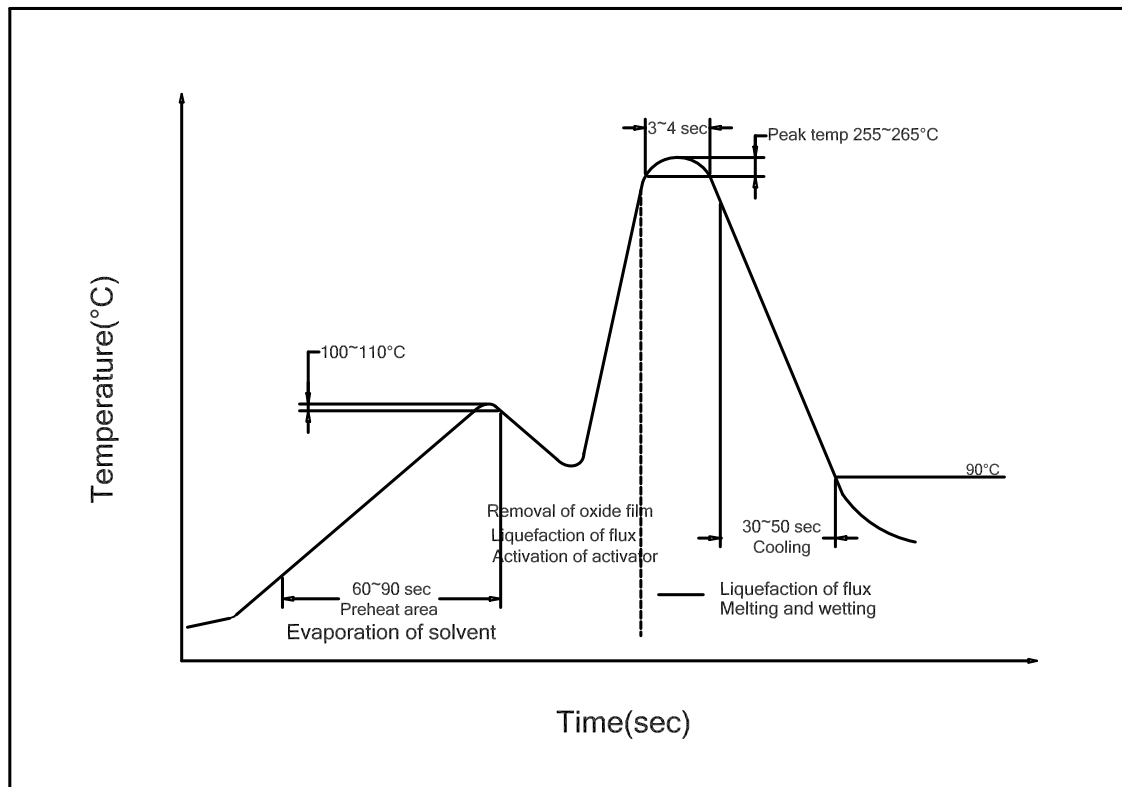

- Tip Temperature :265°C MAX.
- Tip Temperature Time: 4sec MAX.

Package Specification

14 pieces / tube

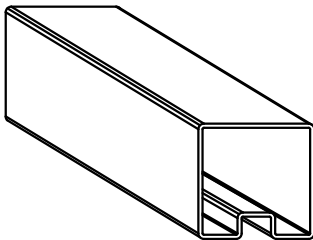
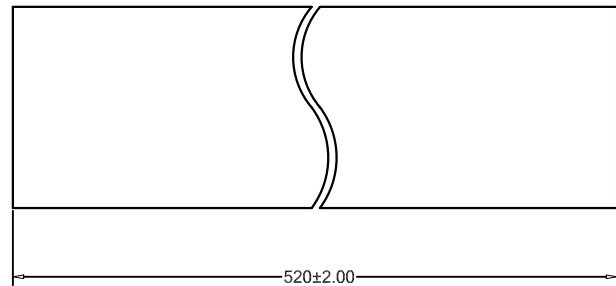
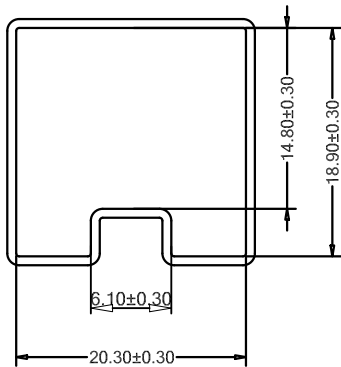

25 TUBE / BOX
350 pieces / BOX

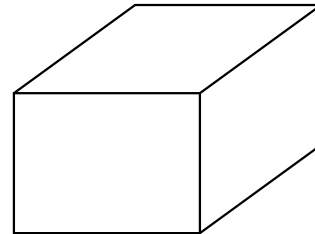
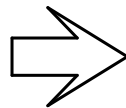

INNER BOX : 530 x 120 x 110

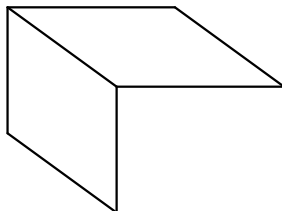

2 BOX / CARTON
700 pieces / CARTON

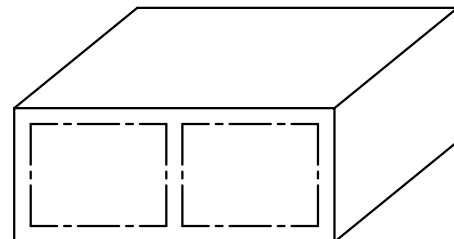
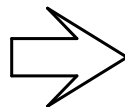

OUTER CARTON : 545 x 255 x 125

Unit : mm